

Supporting Open Scholarship at Swinburne: Swinburne Research Bank, a lean service in a complex environment

Em Johnson (Twitter: @MissEmilieLib)

Friday 25 June 2021



Except where otherwise noted, this slideshow is licensed under the Creative Commons Attribution-NonCommercial 4.0 International License. <http://creativecommons.org/licenses/by-nc/4.0/>

• • • • •
• • • • •

Acknowledgement of Country

We respectfully acknowledge the Wurundjeri People of the Kulin Nation, who are the Traditional Owners of the land on which Swinburne's Australian campuses are located in Melbourne's east and outer-east, and pay our respect to their Elders past, present and emerging.

We are honoured to recognise our connection to Wurundjeri Country, history, culture, and spirituality through these locations, and strive to ensure that we operate in a manner that respects and honours the Elders and Ancestors of these lands.

We also respectfully acknowledge Swinburne's Aboriginal and Torres Strait Islander staff, students, alumni, partners and visitors.

We also acknowledge and respect the Traditional Owners of lands across Australia, their Elders, Ancestors, cultures, and heritage, and recognise the continuing sovereignties of all Aboriginal and Torres Strait Islander Nations.

• •
• •

• • • • • • • • • • • • • •
• • • • • • • • • • • • • •



Some acronyms

OA = open access (mostly specific to research publishing)

OER = open educational resources (supporting curriculum/teaching)

RIMS = research information management system (also ROMS)

Related:

ERA = Excellence in Research Australia (benchmarking)

EI = research engagement and impact

RI = research income (funding/grants etc)

NTRO = non-traditional research objects

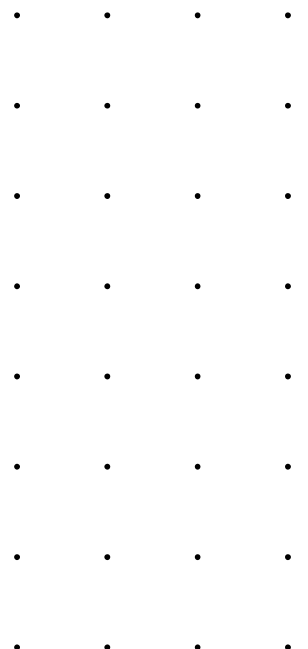

.
.
.

Swinburne Research Bank: timeline and context

.
.
.
.
.
.
.



Timeline: Swinburne's institutional repository

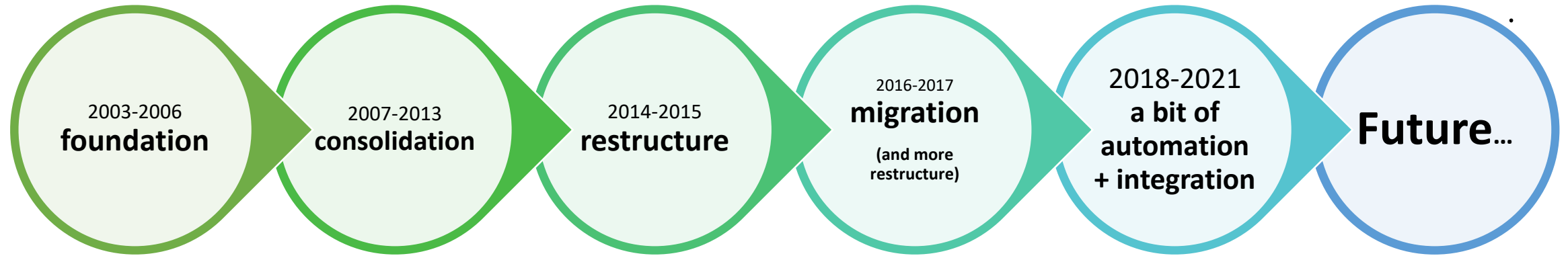

Research Bank is currently structured as:

Team leader (me)	0.8 EFT
+	
service and manual content support	~ 0.8 EFT
systems and batch process support	~ 0.4 EFT

Swinburne's current RIMS ecosystem is duplicated

Research Office

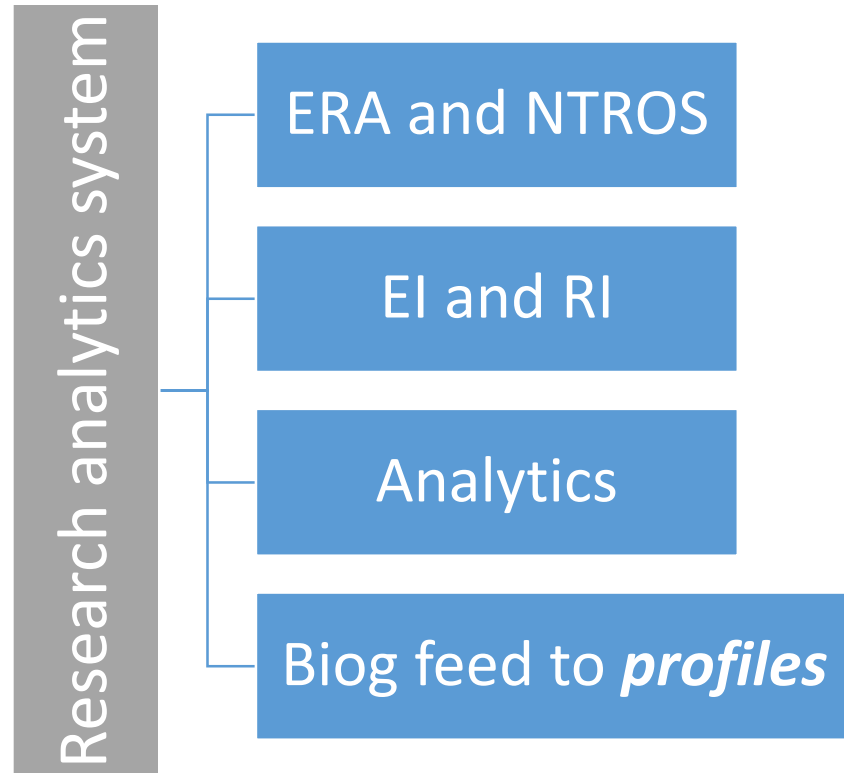

Library

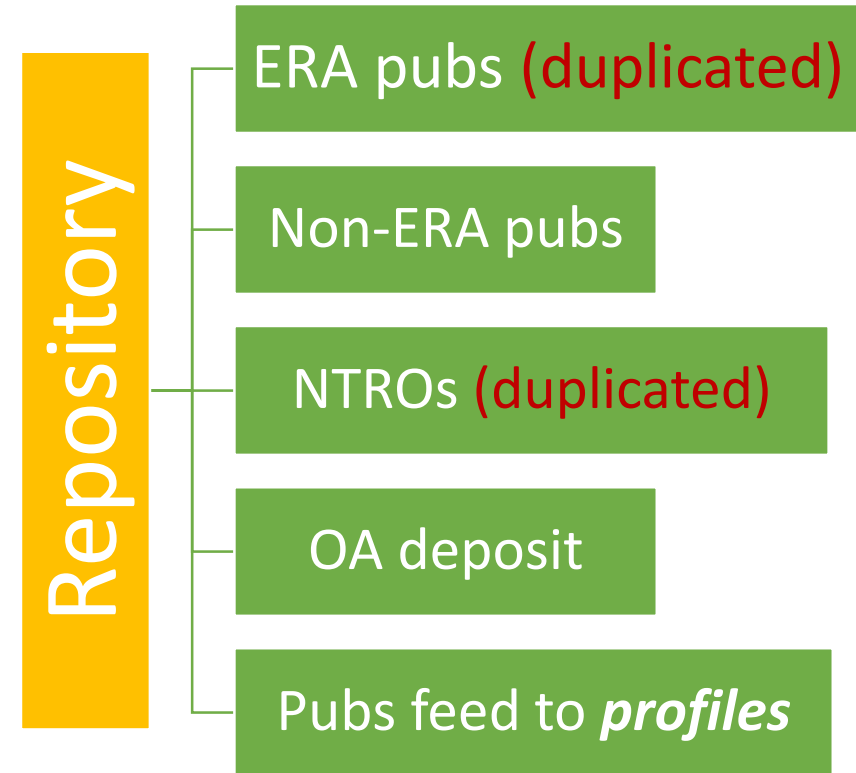

A process and systems mapping exercise in 2018 highlighted all the RIMS

pain points:

all of them.



.
.
.

Communicating and supporting OA

OER versus OA

Apples and oranges and comfort zones



.

Library support for OER
- for curriculum and teaching -
is (largely) about
assisting with access to resources.

This is a comfort zone, for most academic librarians. We know how to do this.

But:

supporting **OA for publishing researchers**
requires learning new/different/specialised skillsets

and involves interacting with/lobbying/educating

the scarier parts of the university



It's complicated.





open science

Swinburne Open Science Task Force Survey: Summary of survey findings

- The first step for the ***Swinburne Open Science Taskforce***
- Convened by the DVC to generate recommendations for
“how Swinburne as an institution can most productively engage with open sciences practices”

See <http://hdl.handle.net/1959.3/461442>

And additional project documentation at <https://osf.io/vpwf7/>

Swinburne Open Science Survey: Perceived Importance & Reported Experience

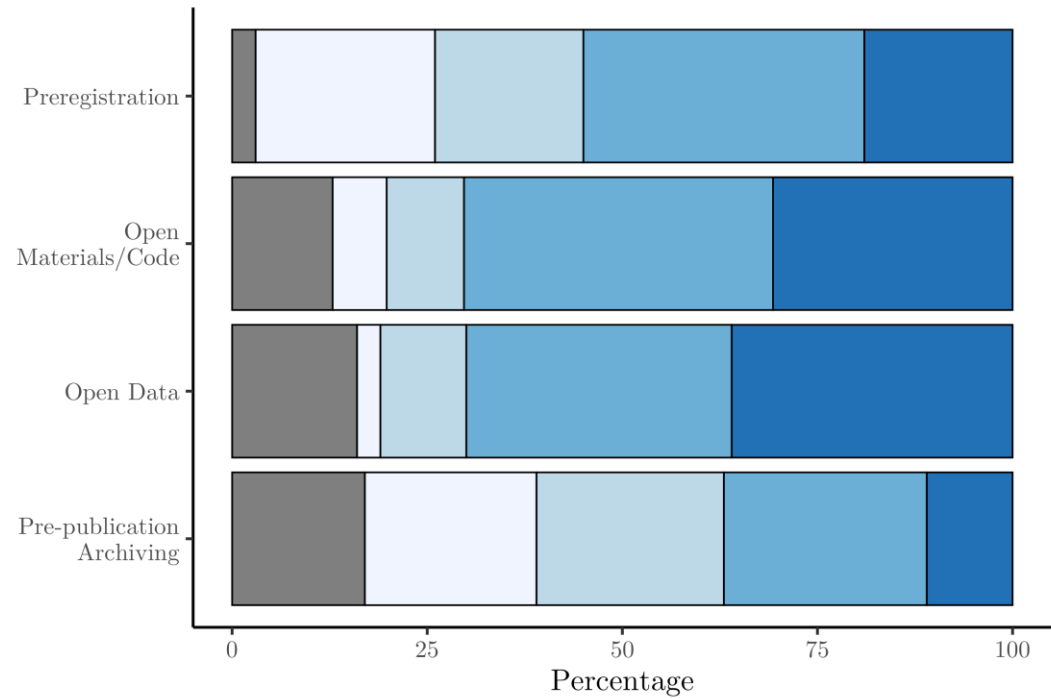

$n = 194$

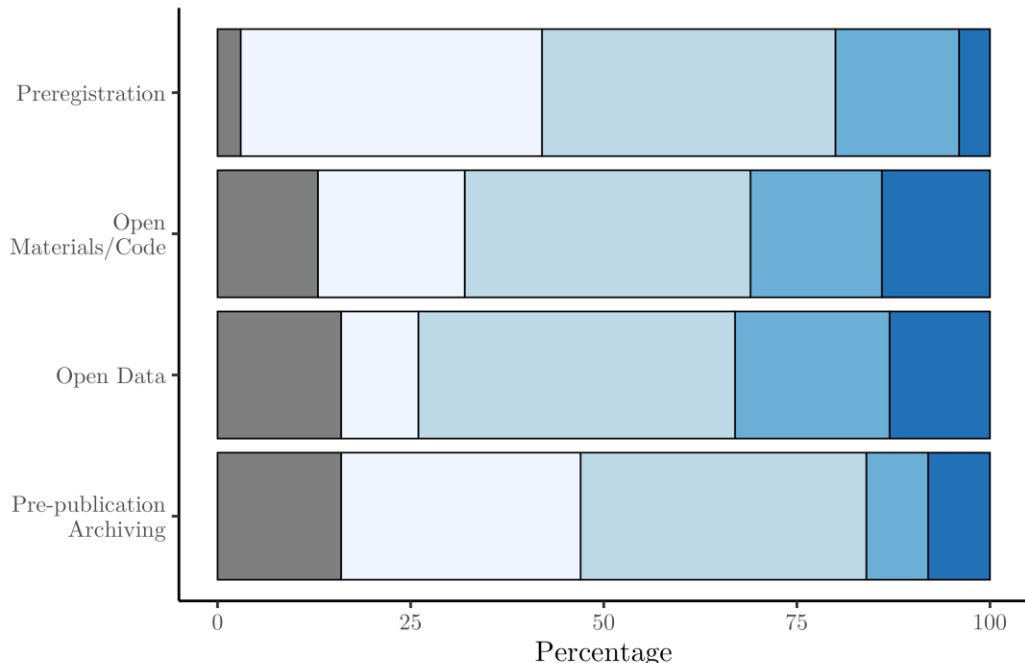
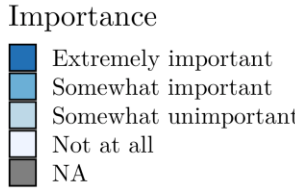

$n = 191$

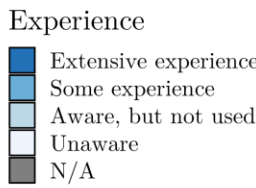

Articulating,
advocating and
supporting...

Some examples



we made our
deposit form as
contextual and
simple to use
as possible

(because we could, with
OpenEquella)

Contribute

Update your publications

[Add a missing work](#)

[Deposit a version for open access](#)

[New to Swinburne? Send us your publication history](#)

[Request a DOI](#)

[Submit a correction to an existing work](#)

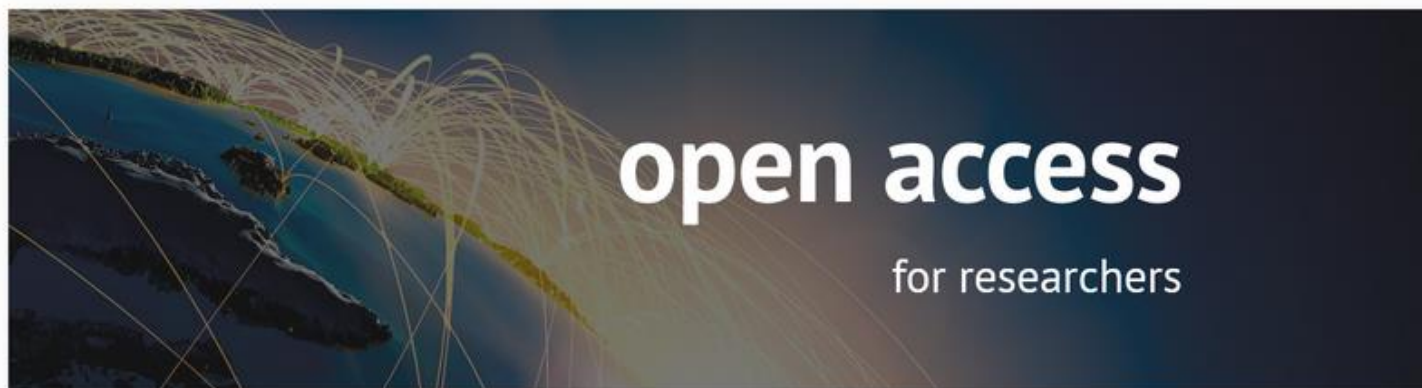

An **information tool** and **service portal** for Swinburne researchers

Contents/navigation

Live search: Open Access wiki



? learn

What is Open Access?

- [Benefits of Open Access](#)
- [Routes to Open Access](#)

+ deposit

Use Swinburne Research Bank to [Deposit for Open Access](#)

[Contact the team](#) or [see our website](#) for more information

i FAQs

[FAQs](#), [mythbusting](#), and [more resources](#)

Open Access.

Open Access research is distributed online, free of cost or other barriers, and with the addition of an open license applied to promote reuse. Find out more about:

- › [Open Access for Swinburne Researchers \(staff login\)](#)
- › [Understand Open Access obligations at Swinburne](#)
- › [Read more about the Australasian Open Access Strategy Group](#)

Benefits of open access include free public access to knowledge (this can be important if the research was publicly funded), a broader research audience, more citations, faster turnaround for scientific review, and broader profile-building and development of professional networks for authors. There are two main models for Open Access Publishing:

1. **Pay to publish/Gold Open Access:** Pay your publisher a fee (Article Processing Charge (APC)) to make the final version of record available for Open Access. Fees are often quite large. The [Open APC Project](#) collates APCs per publisher and journal
2. **Green Open Access*:** This method is free of charges or fees. Publish normally (e.g. on a standard contract) but also deposit the final peer-reviewed manuscript in an open access repository. An embargo might apply. Repositories are available per research area, or per affiliated institution - [Swinburne Research Bank](#) is Swinburne's official Open Access institutional repository.

[Contact Swinburne Research Bank](#)

**All trusted academic publishers also support Green Open Access.*

CONTACTS

› [Who to contact](#)

NEWS



Professor Bronwyn Fox appointed CSIRO Chief Scientist



New digital tool to improve visitors' museum experience



Swinburne and Amaero to work together on space technology

More news ›

Swinburne Statement on Open Science

Swinburne is committed to the principles of transparency and openness in research. We strongly encourage practices that increase the validity, re-use and impact of our research. We commit to supporting an environment that values broad and timely access to research outputs to maximise public access and benefit. Specifically, Swinburne actively encourages a culture where researchers, when possible to:

- › Preregister research plans
- › Use open source code and software for [data](#) collection and processing
- › Use open data available in research data repositories
- › Make the [data](#) they use, generate or collect Findable, Accessible, Interoperable and Reusable (FAIR)
- › Post manuscripts to preprint servers
- › Publish in [open access](#) journals or books
- › Share [research outputs](#) including publications, code and data by depositing into open repositories
- › Engage in other open practices appropriate to their disciplines.

Researchers are expected to comply with legal and regulatory responsibilities in regard to making their work open, as well as with ethical and cultural guidelines. Swinburne will continue to work with the research community to provide the necessary support to increase the openness of our research.

Meetings with deans: tools for communication

LIBRARY SERVICES FOR RESEARCHERS

OPEN ACCESS PUBLISHING OPTIONS



All options are fully compliant with Copyright/publisher/funder/Swinburne policies.

Gold

Make the published version open access.

This option may attract fees

When your paper is accepted, the publisher asks you to assign copyrights via a publishing agreement and offers you a choice of licenses/publishing options.

Your choice determines the model applied:

Models

- 'Gold open access' = you pay an Article Processing Charge (APC) to license the published version for open access. This fee can cost up to a few thousand AUS per paper*
- Discounted or free Gold open access = Swinburne has arrangements with some publishers to provide discounts to authors via Swinburne's [Read & Publish Agreements](#), see below
- 'Diamond or Platinum open access' = the journal does not charge any fee to publish your work open access

*source: <https://reemaps.infoact-project.org/apcdata/combined#journal>

Read and Publish Agreements

Negotiated on your behalf by the Council of Australian University Libraries.

Swinburne has agreements with some publishers, to reduce or remove author fees for Gold OA:

MDPI (discounted APCs)
CSIRO (no APC)
Portland Press Biochemical Society (no APC)

More Agreements are currently in negotiation!

Green

Make your Accepted Manuscript open access.

This option is cost-free

Deposit now:

researchbank.swinburne.edu.au/openaccess

1. Choose a high-quality journal/traditional publishing model (i.e. do not pay a fee to publish).
2. When your paper is accepted, **deposit your final peer-reviewed Accepted manuscript (author's accepted version)** into Swinburne Research Bank.

Model

- Green open access, or self-archiving = depositing a manuscript version into a publisher-endorsed, institutional open access repository, such as Swinburne Research Bank.

Compliance with funder open access policies

If you are funded by the ARC or the NHMRC, or any European funder associated with Plan S (www.coalition-s.org/), you must deposit a minimum amount of information with Swinburne Research Bank in order to comply with your funder's mandatory open access policy.

More information:

www.swinburne.edu.au/library/services/services-for-researchers/research-funding-obligations/

CONTACT: LIBRARY RESEARCH SERVICES TEAM

+61 3 9214 8331 | Researchbank@swin.edu.au

swinburne.edu.au/library/services/services-for-researchers/

Meetings with deans: tools for communication



Now and into the future

A Great Big RIMS project

- Migration, integration, de-duplication
- A new integrated repository
- More capacity for RD support
- Embedded funder/grants > OA compliance workflows and reporting
- ... in time for ERA 2023!

Library 2021 'top priority' strategic planning: **a focus on OA**

- An OA communications strategy
- New services including DOI minting
- Rolling out the CAUL Read&Publish Agreements
- Better, stronger, embedded engagement with OA stakeholders

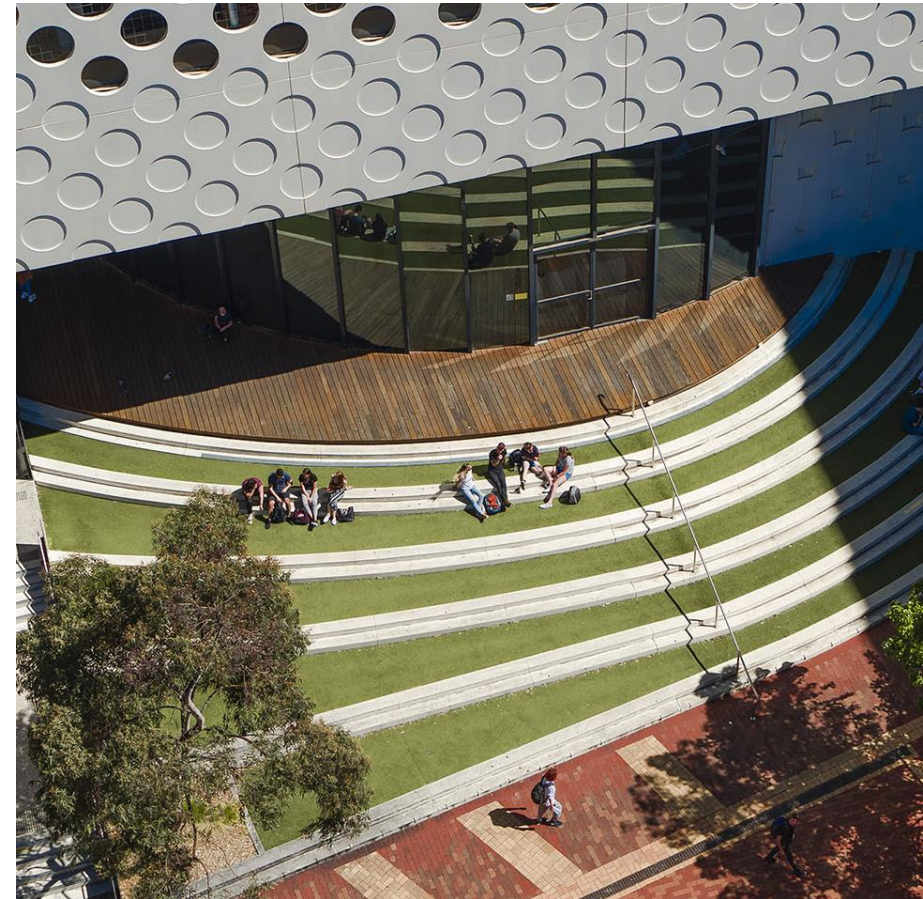

• • • • • • • •
• • • • • • • •
• • • • • • • •



Em Johnson

Friday 25 June 2021

Contact:
eljohnson@swin.edu.au
@MissEmilieLib
03 9214 8331 (when on campus)

• • • • • • • • •
• • • • • • • • •
• • • • • • • • •

Acknowledgments

The **Swinburne Open Science Taskforce** for use of their survey results slide
•
•
Open Access Australia, as always, for your excellent resources and advocacy
•
•
My colleagues in the Library and the research office, for your unstinting support
•
•
CRIG and the organising committee for inviting me today
•

• • • • • • • • •